

# SATO GENERATION 1 - INSTALLATION GUIDE

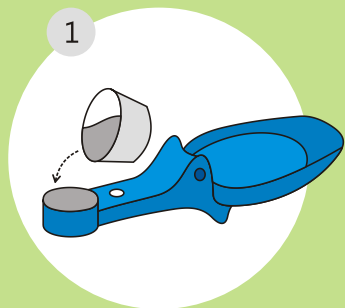

1  
Fill the cup of Flap Door with sufficient cement paste

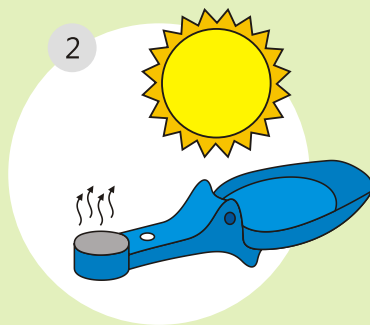

2  
Allow it to dry

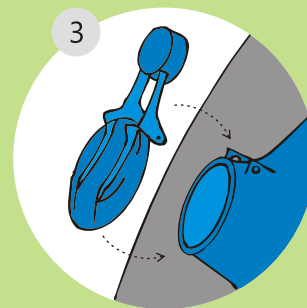

3  
Connect Flap Door with pan

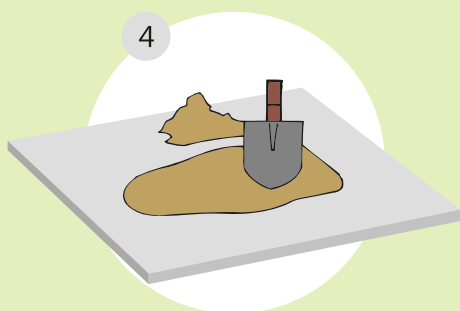

4  
Dig according to the size of collection box

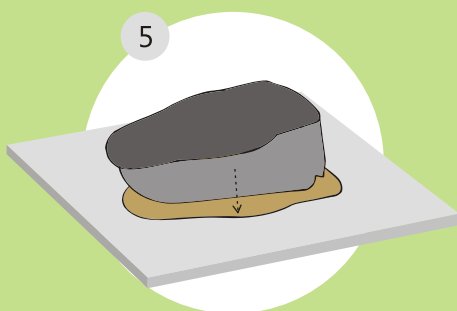

5  
Put collection box inside the dig

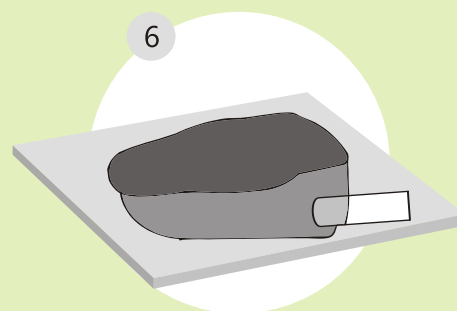

6  
Connect the pipe with collection box

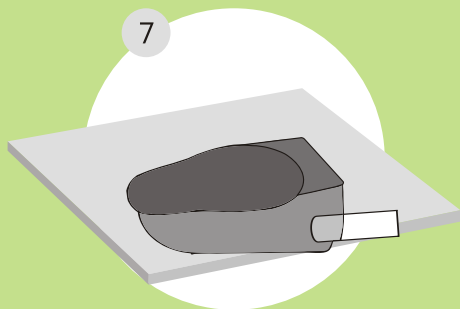

7  
Close flap

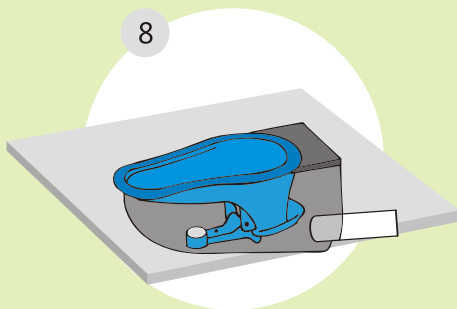

8  
Attach pan

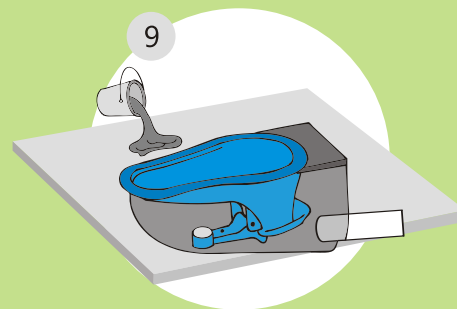

9  
Construct concrete flooring

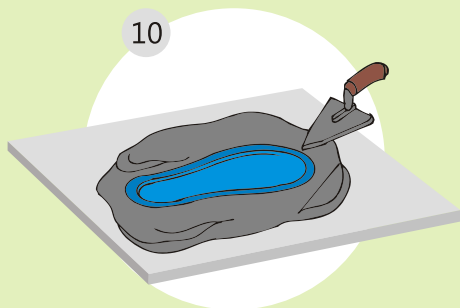

10  
Spread the mixture of sand and cement paste

